

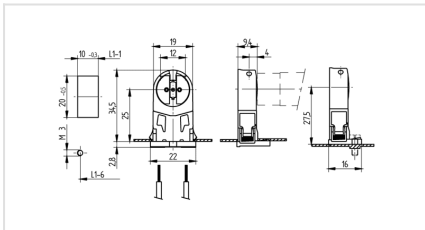

26.620.2012

Linear Fluorescent Lampholders: General Applications
G5 (T5): Push-Through Lampholders



Color: weiß
FC: 50
Part no.: 26.620.2012.50



0,5 - 1,0 mm²

0,5 - 1,5

Description

- For enclosed cut-outs: 10 x 20 mm
-
- A pair of lampholders provides a lamp length tolerance compensation of 2 mm

Product name:	Fluorescent lampholder G5
LED type:	G5
Farbe:	white
Mounting method 1:	Snap-in / screw mount foot
Material:	Housing: PC Rotor: PBT
Rotor:	with
cULus file no.:	E-92235
Weight:	3
Approval:	cULus
Front Test:	yes
Lamp center:	25 / 27.5
Material thickness:	0,3 - 1,2
T-Marking:	140
Top Test:	yes
Pkg.:	1000